

Drain: SPRINGMILL RUN DRAIN Drain #: 310  
Improvement/Arm: UNIVERSITY HIGH SCHOOL  
Operator: JOH Date: 7-6-04  
Drain Classification: Urban/Rural Year Installed: 2002

### GIS Drain Input Checklist

- Pull Source Documents for Scanning JA
- Digitize & Attribute Tile Drains \_\_\_\_\_
- Digitize & Attribute Storm Drains \_\_\_\_\_
- Digitize & Attribute SSD \_\_\_\_\_
- Digitize & Attribute Open Ditch \_\_\_\_\_
- Stamp Plans \_\_\_\_\_
- Sum drain lengths & Validate \_\_\_\_\_
- Enter Improvements into Posse \_\_\_\_\_
- Enter Drain Age into Posse \_\_\_\_\_
- Sum drain length for Watershed in Posse \_\_\_\_\_
- Check Database entries for errors \_\_\_\_\_

**Gasb 34 Footages for Historical Cost  
Drain Length Log**

Drain-Improvement: University High School Arm

Drain Type:	Size:	Length ( )	Length (DB Query)	Length Reconcile	(Applicable)	
					Price:	Cost:
RCP	24"	423			\$18.00	\$7614.00
HDPE	24"	302			\$9.78	\$2953.56
RCP	36"	14			\$32.25	\$451.50
Twin RCP	24"	52			\$18.00	\$1872.00
open ditch	-	590'			\$19.55	\$11,534.50

Sum: 1381 \$ 24,425.56

Final Report: \_\_\_\_\_

Comments:  
\* Suzanne Mills 11-19-03 - NO Bond  
 \_\_\_\_\_  
 \_\_\_\_\_  
 \_\_\_\_\_  
 \_\_\_\_\_  
 \_\_\_\_\_

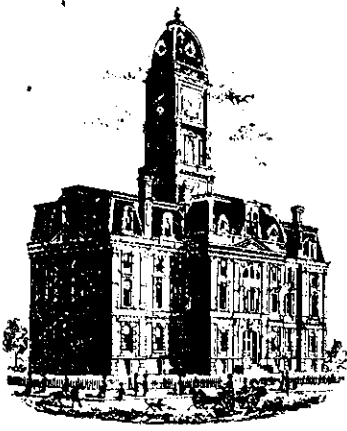

SURVEYOR'S OFFICE

# Hamilton County

*Kenton C. Ward, Surveyor*

*Phone (317) 776-8495*

*Fax (317) 776-9628*

*Suite 188*

*One Hamilton County Square  
Noblesville, Indiana 46060-2230*

October 14, 2002

To: Hamilton County Drainage Board

Re: University High School Arm, Spring Mill Run Drain

Attached is a petition, non-enforcement request, plans, calculations, quantity summary and assessment roll for the University High School Arm, Springmill Run Drain. I have reviewed the submittals and petition and have found each to be in proper form.

I have made a personal inspection of the land described in the petition. Upon doing so, I believe that the drain is practicable; will improve the public health; benefit a public highway and be of public utility; and that the cost, damages and expenses of the proposed drain will probably be less than the benefits accruing to the owners of land likely to be benefited. The drain will consist of the following:

24" RCP	423 ft	36" RCP	14 ft	Open Ditch	590 ft
24" HDPE	302 ft	Twin 24" RCP	52 ft		

The total length of the drain will be 1,381 feet.

The open drain which is listed above is that portion of drain between the west property line of tract 17-13-05-00-00-003.002 and Str. 23 as shown on the plans for University High School by Ogle, McGuire and Shook Corporation, dated June 7, 2002. The open ditch also consists of the portion of drain included as part of the detention facilities between Str. 25 and 27, Str. 28 and 29 and Str. 30 to the south line of tract 17-13-05-00-00-005.001. The drain connects at this point with the existing Springmill Run Drain as located at the north property line of Kings Mill Section 4, Lot 91. (See my report dated March 17, 1999 for Spring Mill Run Drain, Kingsmill Section 4 Arm)

The detention area located between Str. 25 and 27 and between Str. 28 and 29 is to be considered part of the regulated drain. The maintenance, such as mowing, of the dry pond will be the responsibility of the High School. The Board will retain jurisdiction for ensuring the storage volume for which the pond was designed will be retained. Thereby, allowing no fill or easement encroachments. The easement for this area downstream of Str. 25 and upstream of Str. 23 will be as set out in IC 36-9-27-33(A).

I have reviewed the plans and believe the drain will benefit each tract equally. Therefore, I recommend each lot be assessed equally. I also believe that no damages will result to landowners by the construction of this drain. I recommend a maintenance assessment of \$2.00 per acre, with a \$25.00 minimum. With this assessment the total annual assessment for this drain/this section will be \$153.52.

Parcels assessed for this drain may be assessed for the Osborn-Collins or Williams Creek Drain at sometime in the future.

I believe this proposed drain meets the requirements for Urban Drain Classification as set out in IC 36-9-27-67 to 69. Therefore, this drain shall be designated as an Urban Drain.

I recommend that upon approval of the above proposed drain that the Board also approve the attached non-enforcement requests. These requests are for the reduction of the regulated drain easement to those easement widths as shown on the construction plans for the pipe section of the above described drain from Str. 23 to Str. 25 for University High School dated June 7, 2002 by the Ogle, McGuire and Shook Corporation. This section is that portion of the drain which crosses tract 17-13-05-00-00-003.002 and 17-13-05-00-00-003.000.

I recommend the Board set a hearing for this proposed drain for November 25, 2002.

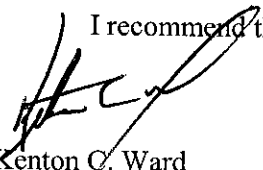

Kenton C. Ward  
Hamilton County Surveyor

KCW/llm

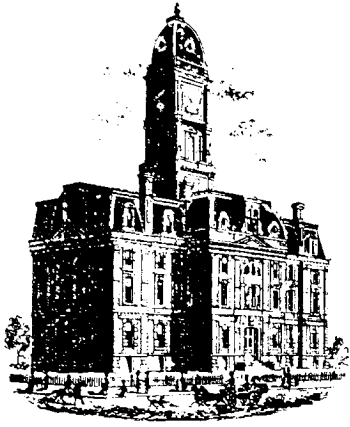

SURVEYOR'S OFFICE

# Hamilton County

Kenton C. Ward, CEM  
 Surveyor of Hamilton County  
 Phone (317) 776-8495  
 Fax (317) 776-9628

Suite 188  
 One Hamilton County Square  
 Noblesville, Indiana 46060-2230

To: Hamilton County Drainage Board

August 16, 2006

Re: Springmill Run Drain – University High School Arm

Attached are as-builts, certificate of completion & compliance, and other information for University High School Arm. An inspection of the drainage facilities for this section has been made and the facilities were found to be complete and acceptable.

During construction, changes were made to the drain, which will alter the plans submitted with my report for this drain-dated October 14, 2002. The report was approved by the Board at the hearing held November 25, 2002. (See Drainage Board Minutes Book 6, Pages 498-499)

The changes are as follows:

Structure:	Length:	Size:	Material:	Up Invert:	Dn Invert:	Grade:	Changes(ft):
23-24	415	24	RCP	890.45	889.49	0.2	-8
24-25	303	24	HDPE	889.49	887.73	0.6	1
B1-E1	23	12	POLY			1.7	23
27-28	21	*24	RCP	883.9	883.71	0.9	7
29-30	60	24	RCP-TWIN	883.81	883.22	1	8
*Was downsized from 36" RCP							
<b>Pipe Totals:</b>						<b>Other Drain:</b>	
24 RCP	436					open ditch	1030
Twin 24" RCP	60						
24 HDPE	303						
12 POLY	23						
<b>Total:</b>	<u>822</u>					<b>Total:</b>	<u>1030</u>

The length of the drain due to the changes described above is now **1,852 feet**.

The non-enforcement was approved by the Board at its meeting on November 25, 2002 and recorded under instrument #200300011381 and #200300011381. This project did not require that sureties be posted.

I recommend the Board approve the drain's construction as complete and acceptable.

Sincerely,

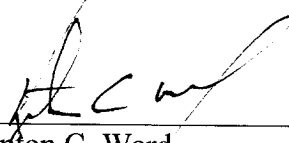
A handwritten signature in black ink, appearing to read 'K C Ward', written over a horizontal line.

Kerton C. Ward,  
Hamilton County Surveyor

KCW/slm

# HAMILTON COUNTY SURVEYOR'S OFFICE

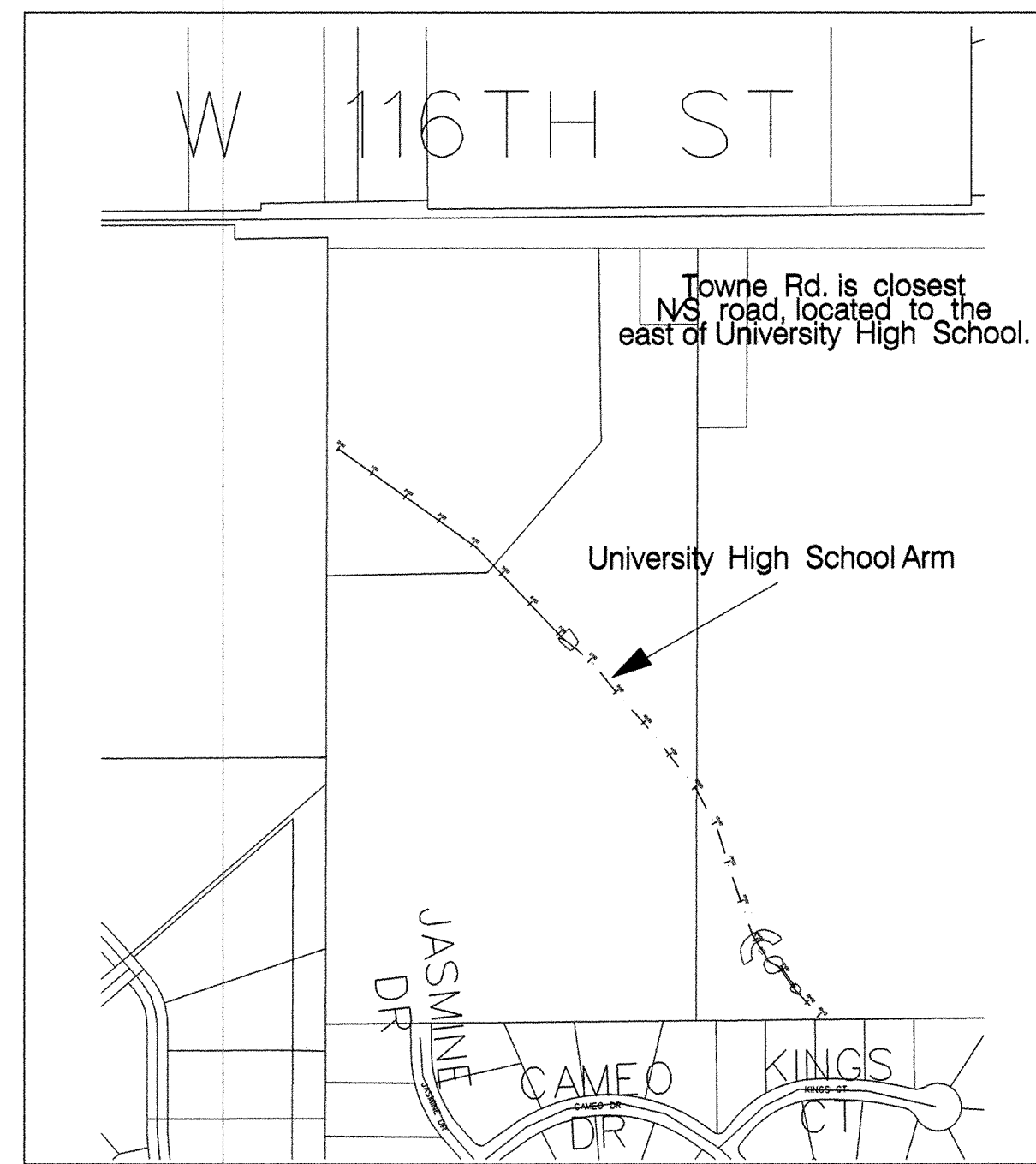

SITE LOCATION MAP



HAMILTON COUNTY SURVEYOR'S OFFICE

---

KENTON C. WARD, COUNTY SURVEYOR

---

HAMILTON COUNTY DRAINAGE BOARD

---

STEVEN A. HOLT, PRESIDENT  
 CHRISTINE ALTMAN, MEMBER  
 STEVEN C. DILLINGER, MEMBER  
 JERRY RULON, ALTERNATE MEMBER

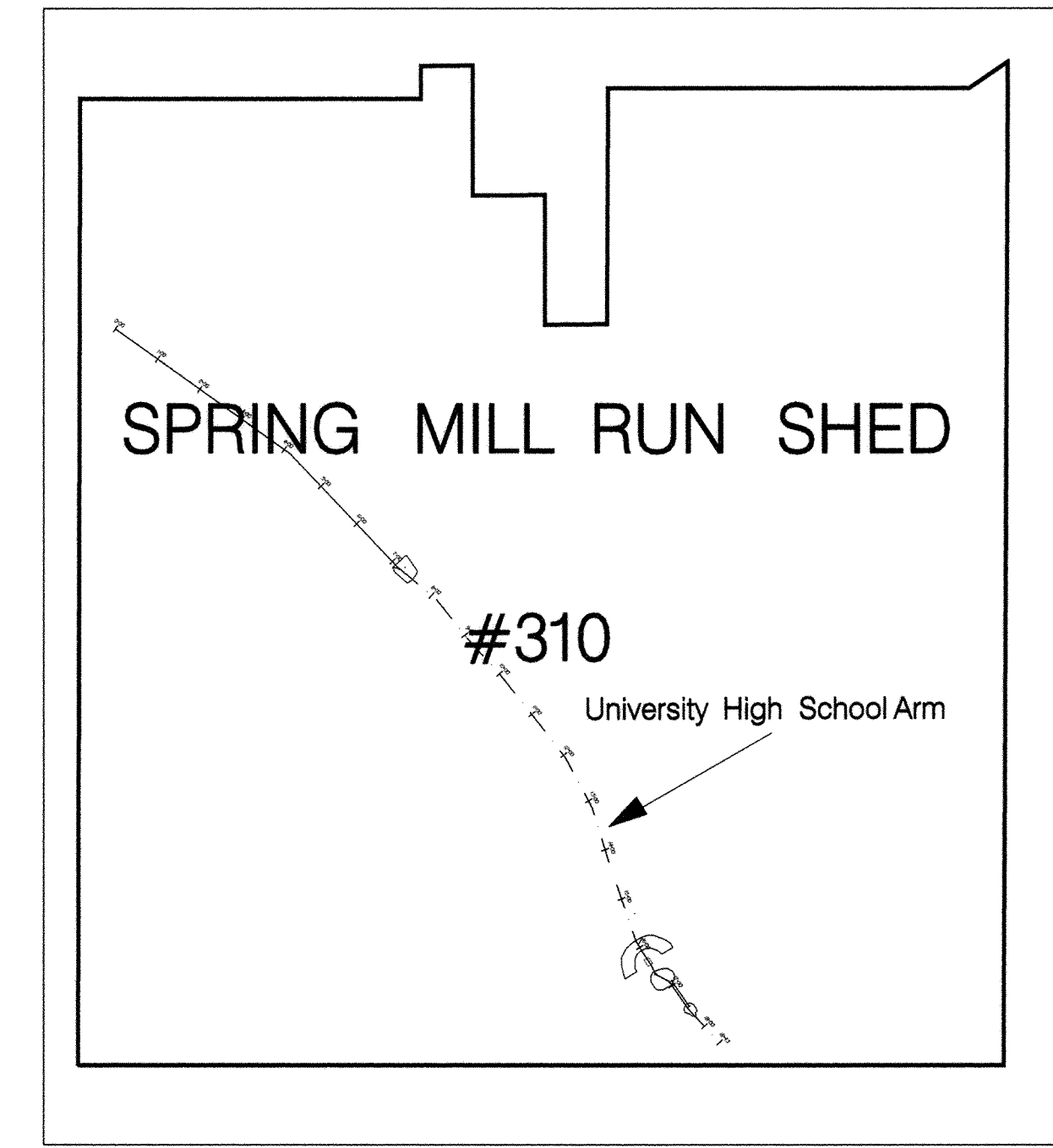

WATERSHED AREA

## University High School Arm Spring Mill Run Drain As-Built

INDEX	
SHEET NO.	Description
1-2	Plan and Profile Sheet

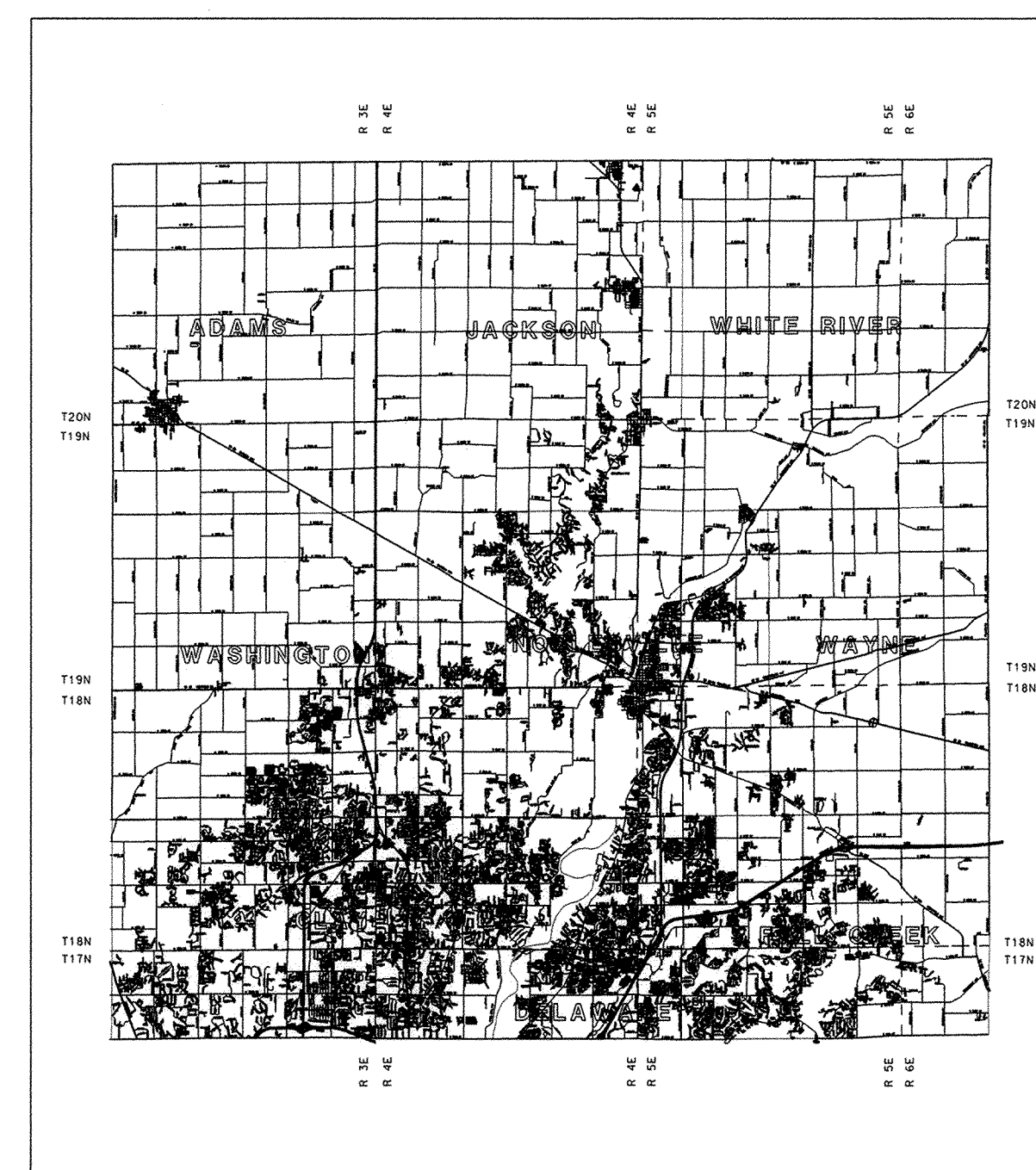

HAMILTON COUNTY

Operating Authorities	

HAMILTON COUNTY, INDIANA

Hamilton County Surveyor's Office  
 Hamilton County Government and  
 Judicial Center  
 One Hamilton County Square, Suite 188  
 Noblesville, IN 46060  
 (317) 776-8425  
 surveyor@co.hamilton.in.us

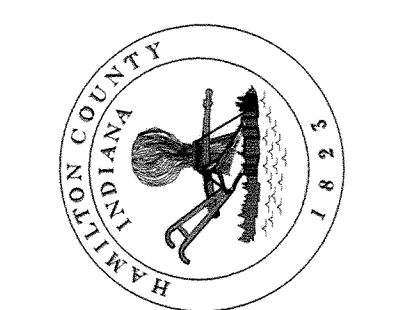

Project No: HCSO-2006-UNI  
 Watershed No:  
 Dgn Name: Brandywine.dgn  
 Field By:  
 Drawn By: RAE  
 Checked By:  
 Date:

By:  
 Date: 7-20-06

Revisions:

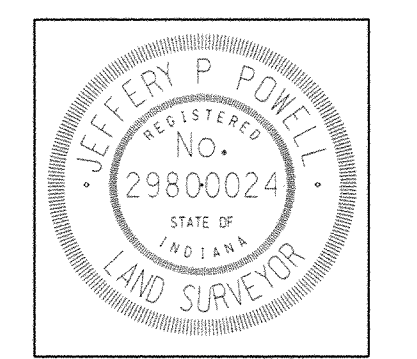

Certified By:  
*Jeffrey Powell*  
 Jeffrey Powell L.S.

Project Name:  
 University High School Arm  
 As-Built  
 Title Sheet

PLLOT DATE: \$\$\$\$\$\$DATE\$\$\$\$\$\$

STA 0+00  
STR 23 End Section  
INV OUT= 890.45

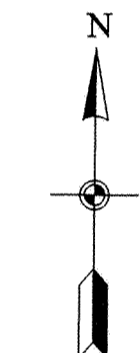
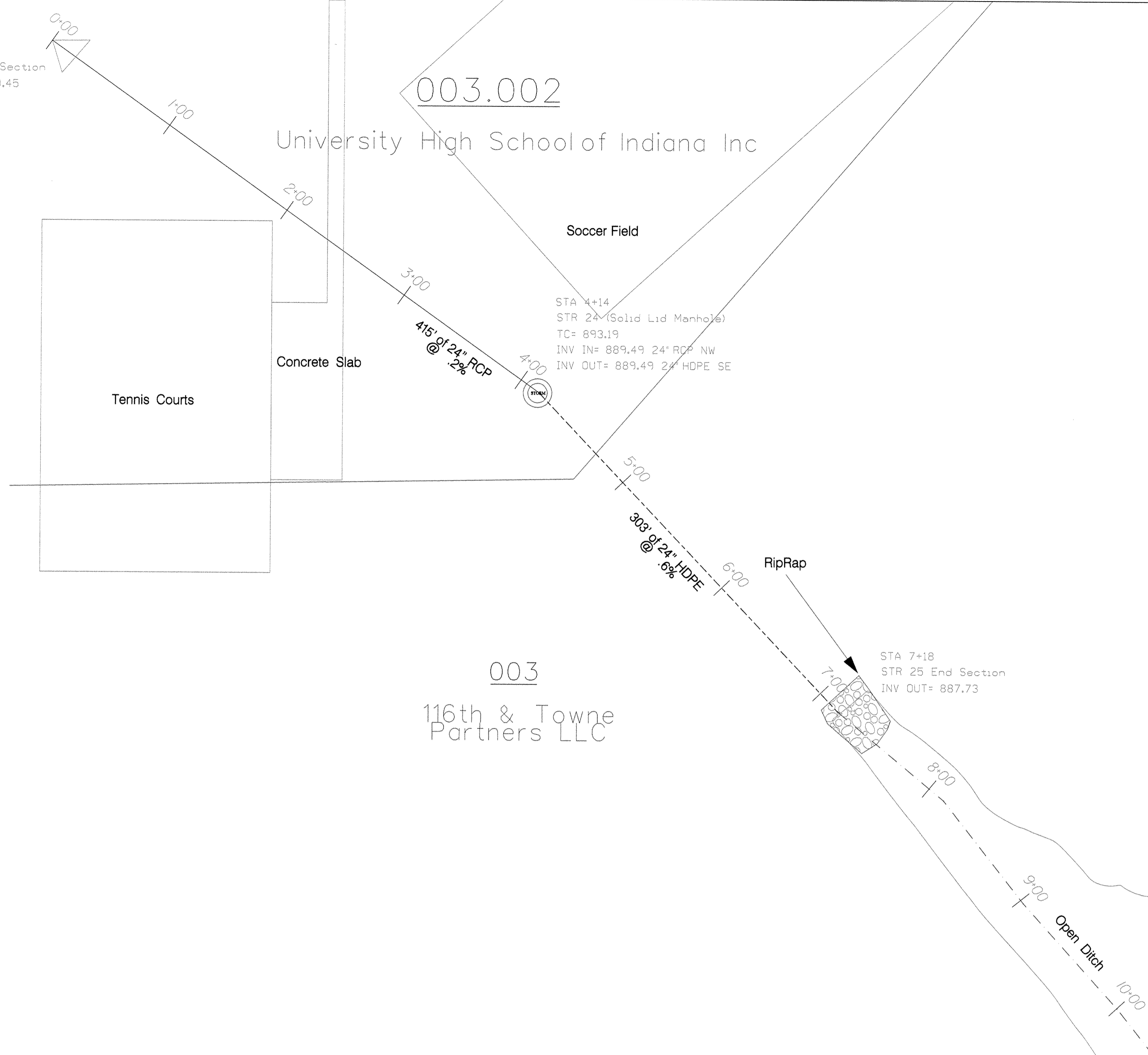

PLAN VIEW

SCALE 1" = 50'

PROFILE VIEW

HORIZONTAL SCALE 1" = 50'

VERTICAL SCALE 1" = 5'

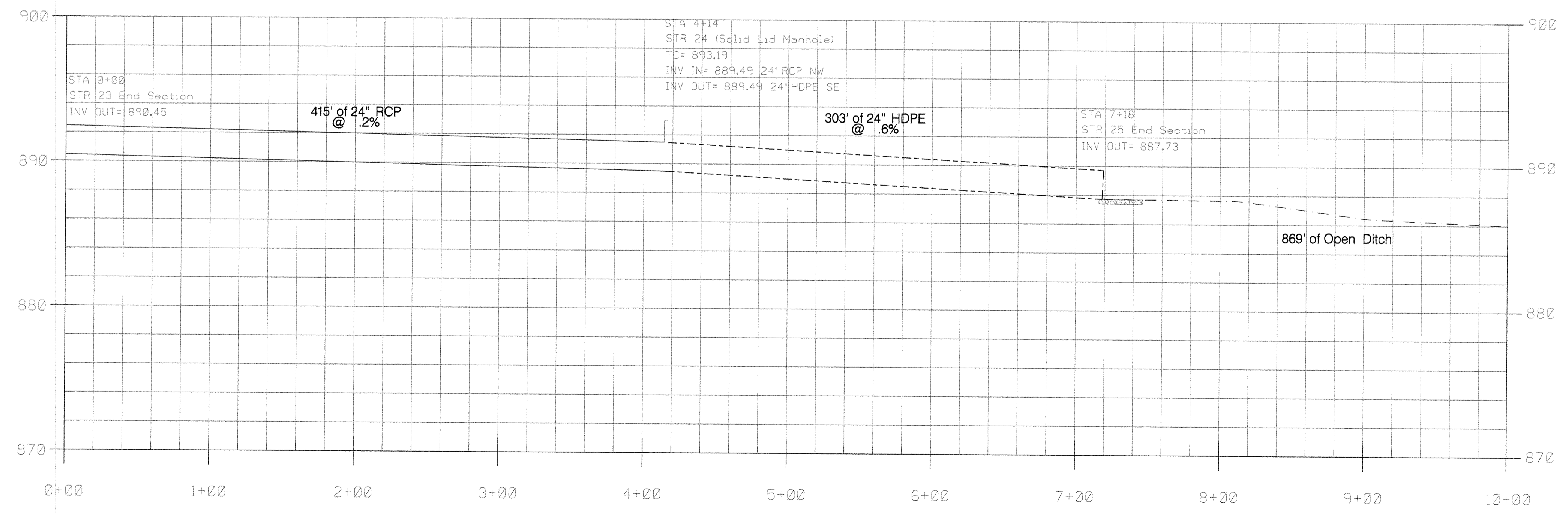

**HAMILTON COUNTY, INDIANA**  
Hamilton County Surveyor's Office  
Hamilton County Government and  
Judicial Center  
County Square, Suite 188  
Noblesville, IN 46060  
(O) 776-8495  
(F) 776-9628  
surveyor@co.hamilton.in.us

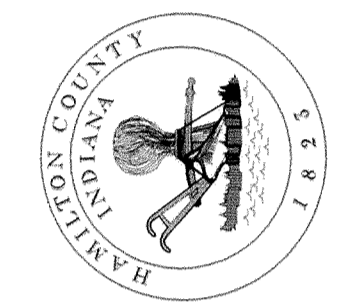

Project No:	HCSO-2006-LNI
Watershed No:	
Dgn Name:	
Field By:	RAE
Drawn By:	
Checked By:	
Date:	

By: \_\_\_\_\_  
Date: 7-20-06

Revisions:

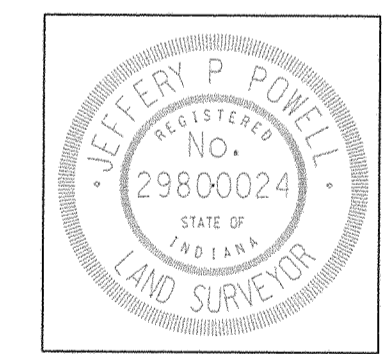

Certified By:  
*Jeffrey Powell*  
Jeffery Powell L.S.

Project Name:  
University High School Arm  
As-Built  
As-Built

PLLOT DATE: \$\$\$\$\$\$DATE\$\$\$\$\$\$

SHEET NO.  
1 of 2



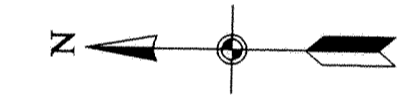
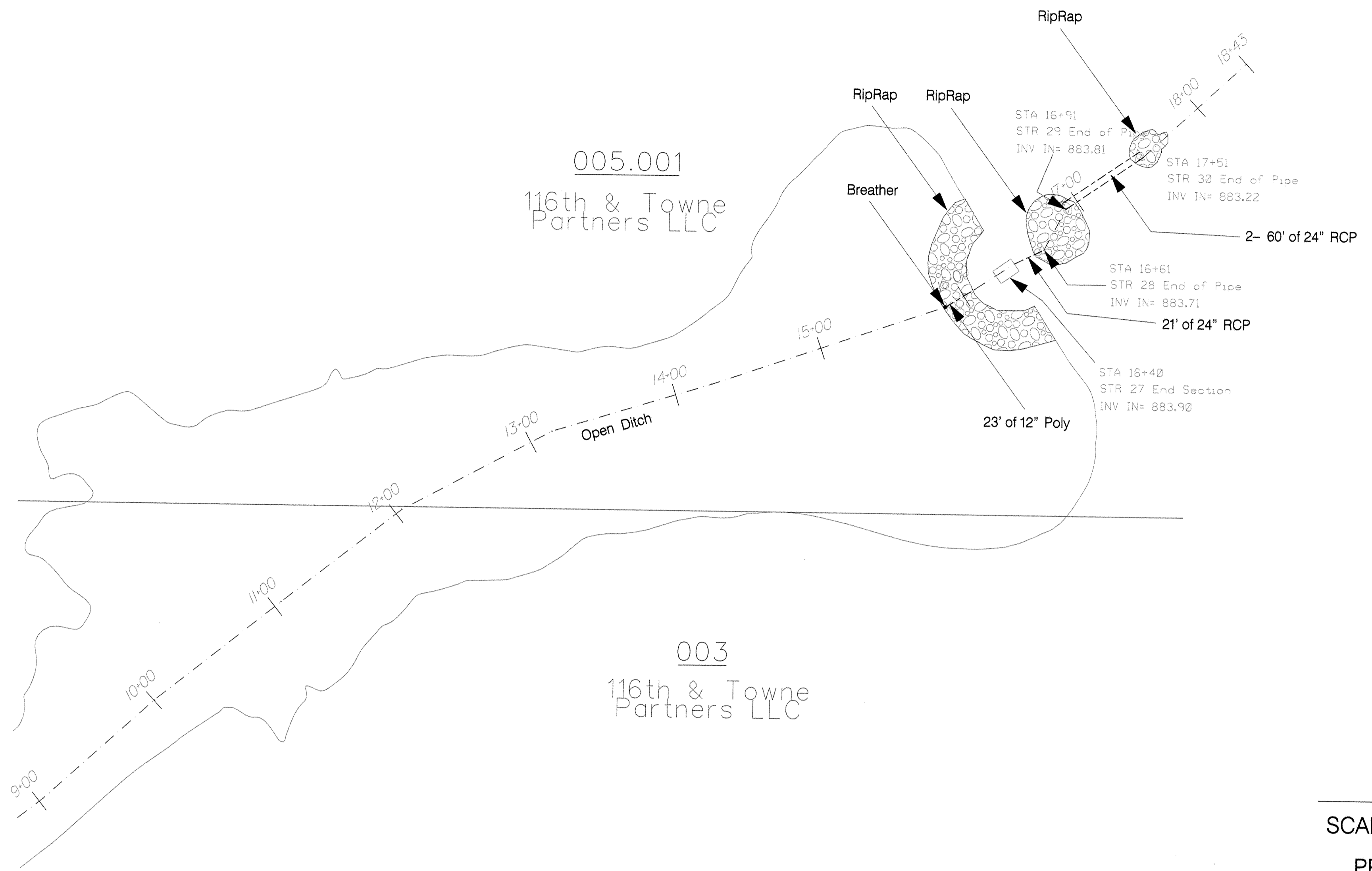

PLAN VIEW

SCALE 1" = 50'

PROFILE VIEW

HORIZONTAL SCALE 1" = 50'

VERTICAL SCALE 1" = 5'

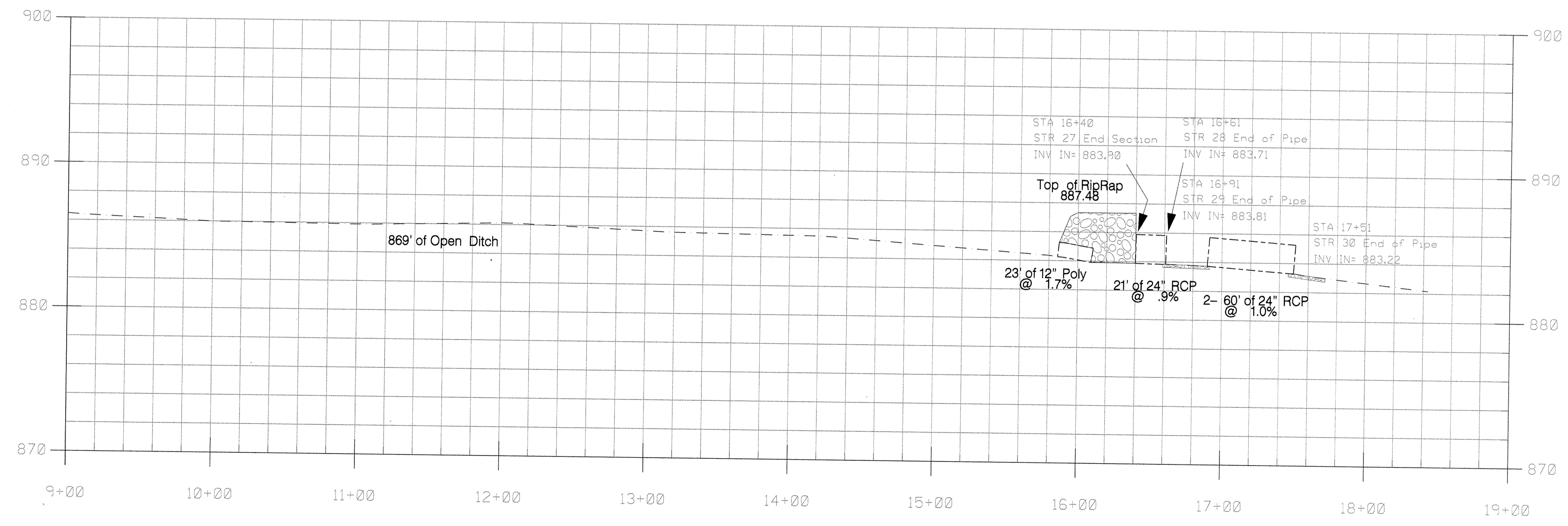

005.001  
116th & Towne  
Partners LLC

003  
116th & Towne  
Partners LLC

HAMILTON COUNTY, INDIANA

Hamilton County Surveyor's Office  
Hamilton County Government and  
Judicial Center  
One Hamilton County Square, Suite 188  
Noblesville, IN 46060  
(317) 776-9628  
surveyor@co.hamilton.in.us

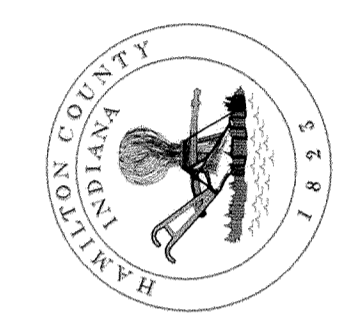

Project No:	HCSO-2006-UNI
Watershed No:	
Dgn Name:	
Drawn By:	RAE
Checked By:	
Date:	

By:	
Date:	7-10-06

Revisions:	
------------	--

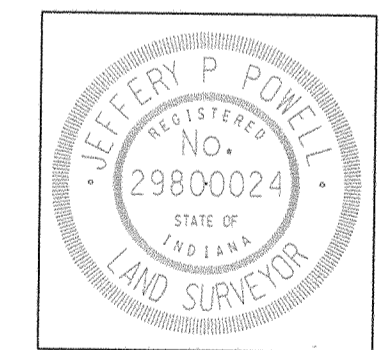

Certified By:  
*Jeffery Powell*  
Jeffery Powell L.S.

Project Name:  
University High School Arm  
As-Built

As-Built

PLOT DATE: \$\$\$\$\$\$DATE\$\$\$\$\$\$

SHEET NO.  
2 of 2